



VOLVO C30

QUICK GUIDE



WELCOME TO THE GLOBAL FAMILY OF VOLVO OWNERS!

Getting to know your new vehicle is an exciting experience.

Please browse through this Quick Guide to get the full benefits from your new Volvo. For detailed information, please refer to your Owner's Manual.

Warning texts and other important information are only provided in the Owner's Manual - not in this folder. The Owner's Manual contains the most up-to-date information.

For additional information, contact Customer Service:

U.S.A.: 1-800-458-1552 www.volvocars.us

CANADA: 1-800-663-8255 www.volvocanada.com

KEY & REMOTE CONTROL



KEY BLADE

Used to lock/unlock the glove compartment or the driver's door if the vehicle has no electrical current.



Locks the doors and liftgate, and arms the alarm.



Unlocks the doors and liftgate¹ and disarms the alarm.



Unlocks the liftgate. (Does not open the liftgate).



Approach lighting (30 seconds²) illuminates lights in door mirrors, cabin, footwells, license plates. Turn signals and parking lights illuminate.



"Panic" alarm. Press and hold to sound the alarm. Turn off alarm with unlock button.

1. Automatic relock occurs if no door/liftgate is opened within 2 minutes after unlock.

2. The time can be set to 30, 60, or 90 seconds.

COLD START

NOTE

After cold starts, your engine will idle at a higher speed for a short time.

AUTOSTART

Turn the key/keyless drive start control to position **III** and release it. The engine will start automatically.

TURN SIGNALS



A. Lane-change sequence, **three flashes**.
B. **Full turn** sequence.

STEERING WHEEL ADJUSTMENT

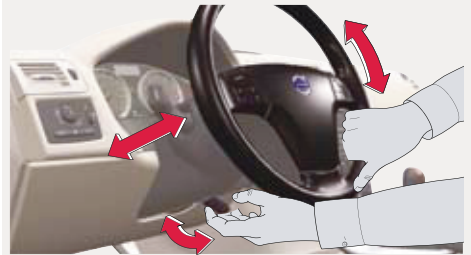

Adjust tilt and telescope.

WARNING! Never adjust the steering wheel while driving.

LIGHTING PANEL



- 0 Automatic headlights.** High beam flash only.
- ☰ Parking lights**
- ☰ Headlights:** turn off when ignition is switched off, high/low beams
- ☹ Display & instrument panel lighting**
- ☰ Front fog lights** (option)
- ☰ Rear fog light** (driver's side only)
- A High beam flash**
- B Toggle between high/low beams, home safe lighting.**



CAR CARE



We do not recommend washing your car in an automatic wash during the first six months because the paint will not have hardened sufficiently.

Leather upholstery requires regular care. Treat the leather with protectant cream, one to four times a year as necessary. Consult your Volvo retailer for leather care products.

STORAGE SPACES, 12-VOLT SOCKET & AUX CONNECTOR (OPTION)



The front and rear **12-volt sockets** function in ignition positions I or II.

AUX makes it possible to connect a portable music player to your audio system. Use a 3.5 mm stereo mini plug.

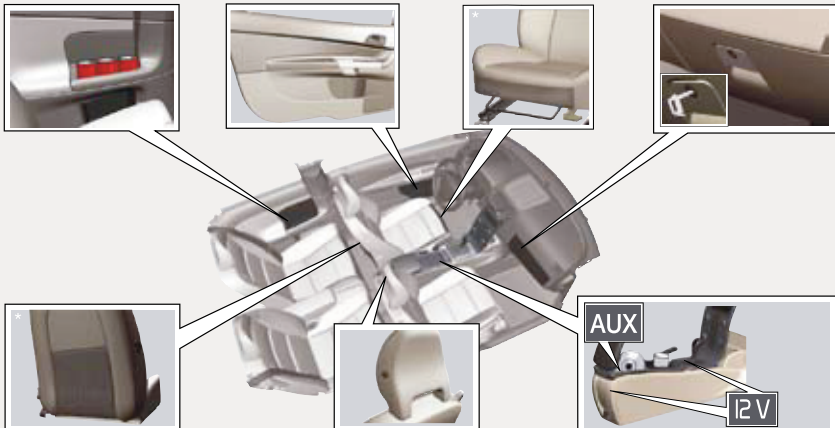

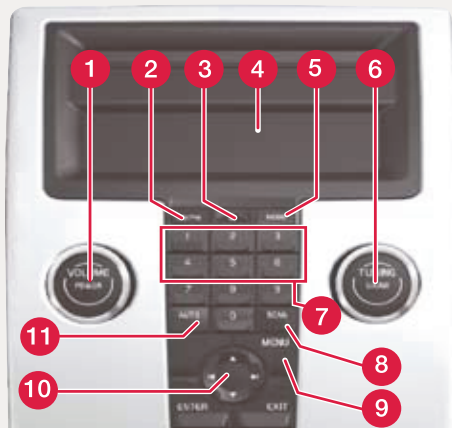

- 1 On/Off and volume.** Press to turn on/off. Turn to adjust volume. Radio and Volvo Navigation System (option) volume are stored individually.
- 2 FM1, FM2 or AM radio**
- 4 Display, clock** is set in personal settings menu.
- 5 MODE, CD, Sirius satellite radio (option), AUX¹**
- 6 Sound settings.** Press to select e.g., BASS, TREBLE, etc. Turn to adjust.
- 9 MENU.** AUX volume and advanced sound settings.

1. AUX connector for e.g., MP3 player. Set MP3 player's volume to medium for best sound quality.

RADIO

- 6** Turn to select a **radio station**.
- 10 Search for stations** with left/right arrows or **SCAN (8)**. **Store up to 20 stations** by pressing and holding one of the preset buttons (7) **0-9** in FM1 and **0-9** in FM2. A stored station is confirmed in the display.
- 11 Autostore stations**
Press **AUTO** for 2 seconds. **AUTOSTORE** is displayed during the search. The 10 strongest stations are stored. Press **0-9** to select a station.

CD PLAYER²

- 10 Change CD tracks** with left/right arrows or turn (6). **Select CD³** with up/down arrows.
- 3 CD eject.** Press to eject current CD. Press and hold to eject all CDs.³
- 7 CD select.³** Press 1-6.

2. CDs containing files in MP3 and WMA formats can also be played.

3. CD changer only (option).

WIPERS AND RAIN SENSOR (OPTION)



- C Single wiper sweep**
- 0 Off**
- D Intermittent wipers.** Turn (2) to adjust interval.
- E Normal speed**
- F High speed**
- G Windshield and headlight washer**
- H Liftgate washer**
- 3 Liftgate wiper interval/normal**

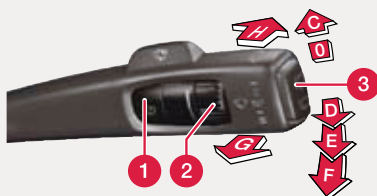

- 1 Activate rain sensor.** Positions **D-F** deactivate the rain sensor.
- 2 Turn to adjust rain sensor sensitivity.**
- Symbol in display** (rain sensor on).



AUTOMATIC CONTROL

In **AUTO** mode, ECC controls all functions automatically and makes driving more pleasant with optimal air quality.

- 1 Automatic mode**
Press **AUTO** to maintain cabin temperature balanced airflow, and other settings.
- 2 Temperature**
Press to individually adjust the left (**L**) or right (**R**) side. Turn the dial to the desired temperature, which is shown in the display.

MANUAL CONTROL

- Blower speed**
- Air distribution**
- Defroster** to quickly remove mist on the windshield and side windows.
- Recirculation**
- AC Air conditioning** off/on.
- Heated rear window and door mirrors.** Timer function.¹

1. Rear window 12 minutes. Mirrors 6 minutes.

TIRE PRESSURE MONITORING SYSTEM (TPMS)



When a low tire pressure warning message has been displayed and the tire pressure warning light has come on, one or more tires has low inflation pressure.

Stop the vehicle in a safe place and check the inflation pressure of all four tires with a tire pressure gauge.



FUEL

- 1 Low fuel level indicator**
When the symbol illuminates, there are 2.1 US gallons (8 liters) of fuel remaining.
- 2 Fuel gauge**
The fuel filler door is on the right, as indicated by the arrow.

TRIP ODOMETER

- 5** The **display** shows two separate trip odometers, **T1** & **T2**.
- 3 Press quickly** to toggle between **T1** & **T2**. **Press and hold** to reset the displayed odometer.

TRIP COMPUTER



- 6 Press** to erase a displayed message.
- 7 Turn** to display trip computer information (4) such as **MILES TO EMPTY TANK**.
- 8 Reset current function.** A long press resets all functions.

NOTE

MILES TO EMPTY TANK is an approximation, based on recent average fuel consumption.

BLIS – BLIND SPOT INFORMATION SYSTEM (OPTION)



If the BLIS indicator lights illuminate occasionally even when there are no other vehicles in the blind area, this may be caused by light reflected from a wet road surface, the vehicle's own shadow against a large, light, smooth surface, or sunlight directly in the camera when the sun is low on the horizon.

In the event of a fault, **Blind spot syst. service required** will be displayed.

SOFT CARGO AREA COVER (OPTION)

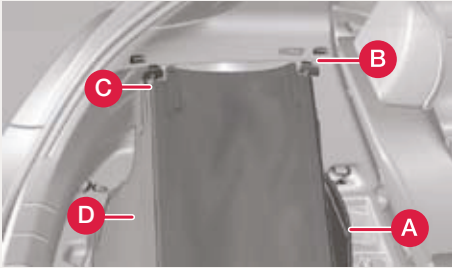

Attach the hooks near the floor (A).

Press together the spring-loaded rails and insert them in the attachments (B) on both sides.

Insert the attachments in (C) in the same way.

Place the hooks in (D).

Remove the attachments at (D) and (C) if necessary on both sides when loading the cargo area.

Remove (D), (C), (B), and (A) and roll up the cover when it is not in use.

HOLDERS FOR FLOOR HATCH

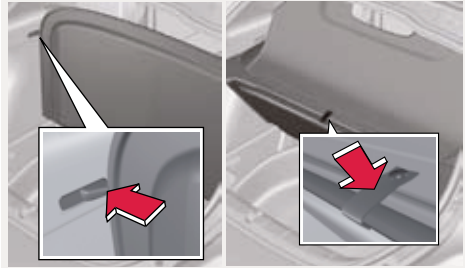

Open floor hatch without/with cargo area cover.

FOLDING DOWN THE REAR SEAT BACKRESTS



RIGID CARGO AREA COVER (OPTION)

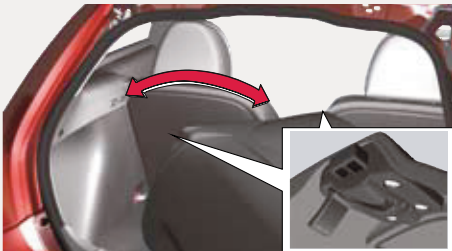

Installing

Pull all four locking buttons back as far as possible. Carefully lift in the cover, place the front section on the two supports behind (A) on both sides.

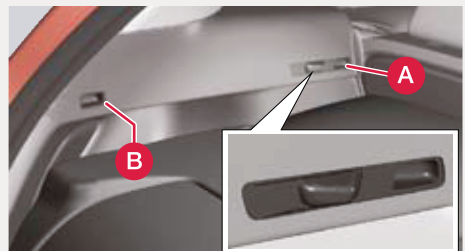

Place one rear lock at (B) and press the lock button forward. Lock the other buttons in the same way.

Removing

Pull the lock buttons rearward as far as possible at (A) first, then at (B). Lift out the cover.

ADJUSTING THE FRONT SEAT



- 1 Lumbar support
- 2 Backrest tilt
- 3 Raise/lower the seat
- 4 Raise/lower the front edge of the seat cushion
- 5 Forward/rearward
- 6 Access to rear seat

ENTERING THE REAR SEAT

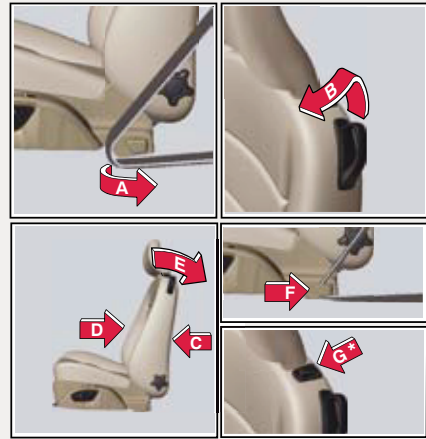

Manual seat

Moving the seat forward:

- A. Remove the seat belt from the guide.
- B. Pull up the handle and hold it up. Fold the backrest forward until it locks in position.
- C. Move the seat forward.

Moving the seat rearward:

- D. Move the seat rearward until it reaches its original position.
- E. When the seat has reached its original position, pull up the handle (B) and return the backrest to the upright position.
- F. Put the seat belt back into the guide.

Power seat (option)

Moving the seat forward:

- A. Remove the seat belt from the guide.
- B. Pull up the handle and fold the backrest forward.
- G. Press and hold the button while the seat moves forward.

Moving the seat rearward:

- G. Hold in the button again reaches its original position. Pull up the handle (B) and return the backrest to the upright position.
- F. Put the seat belt back into the guide.

i NOTE

When putting on the seat belt, it is easiest to reach the lower section of the belt, near the guide, instead of reaching over your shoulder.

REFUELING



Press this button to unlock the fuel filler door.

Recommended octane rating: 91

Minimum octane rating: 87